

# B143 Corner fixing legs metal fitting

● Gap used to happen between table top and legs while using table in case of using the former plate when you install legs on the corners of the table. However, using table hook can avoid having gap and can joint table top and legs more tightly at the same time.

● Recommended leg size/60mm square ~ 75mm square

● Material/Plate•Steel/Table hook•Steel

● Finishing/Table hook•Zink plating

Table hook•Zink

● Recommended installation screw/ Table top side•Truss head Diameter 8mm

Leg side•Countersunk head Diameter 5mm

Table hook•Countersunk head Diameter 5mm

● Quantity/200 pcs



Table hook



Plate

## Feature

Table hook can prevent the plate to float

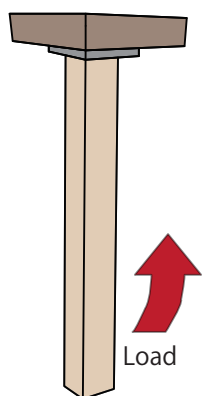

B143

\* Fix the corners tightly

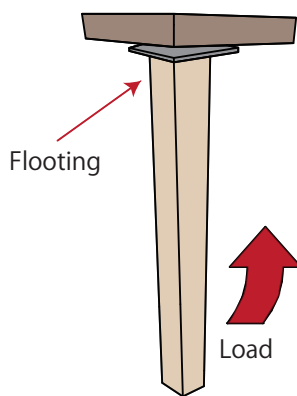

Usual plate

\* Can't fix the corner with screw

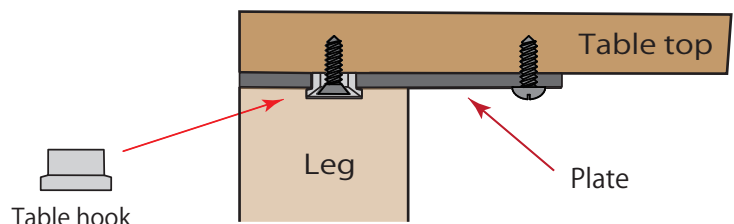

Strong product against diagonal load

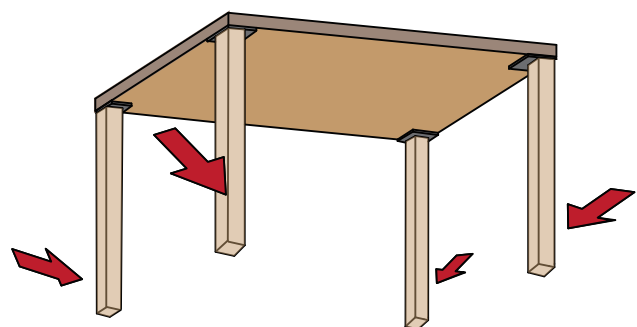

## Metal fitting dimension

Plate

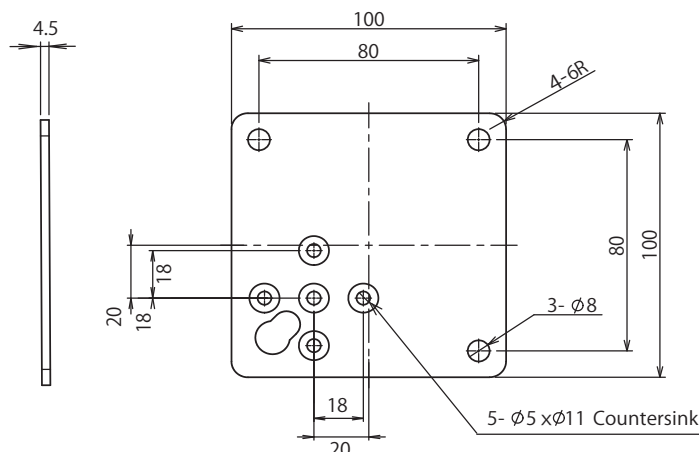
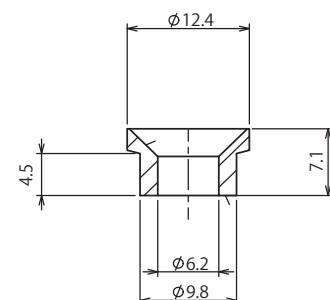
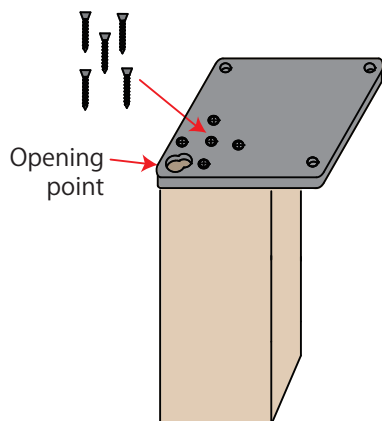

Table hook



## How to install

### ① Table leg



### ② Table top

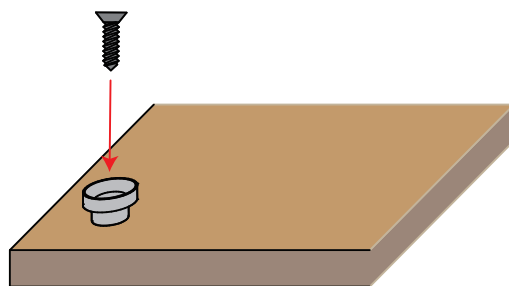

\* Please refer to wooden part processing dimension drawing

### ① Install a plate to leg side

### ② Install a table hook to table top side

\* In case that table hook sinks into wooden part because material of table top is soft, usage E204 insert nut D type or E210 insert nut S type is recommended

## Installation process

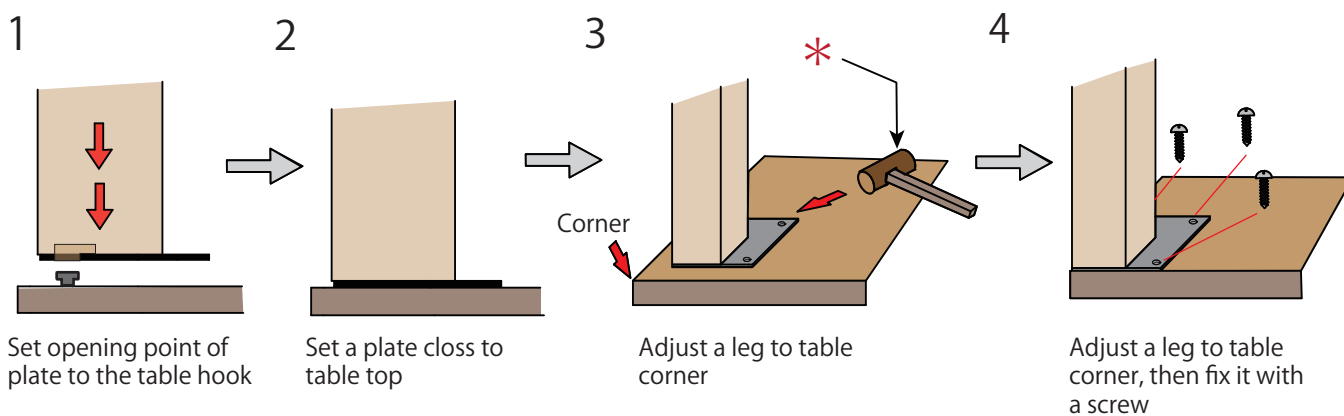

\* It's designed not to make a gap to prevent rattling. At 3, when it's hard to adjust to the corner, push to squeeze into left or right, or hit and push into with a wooden hammer not to hurt furniture.

## Wooden part processing dimension

### Table top

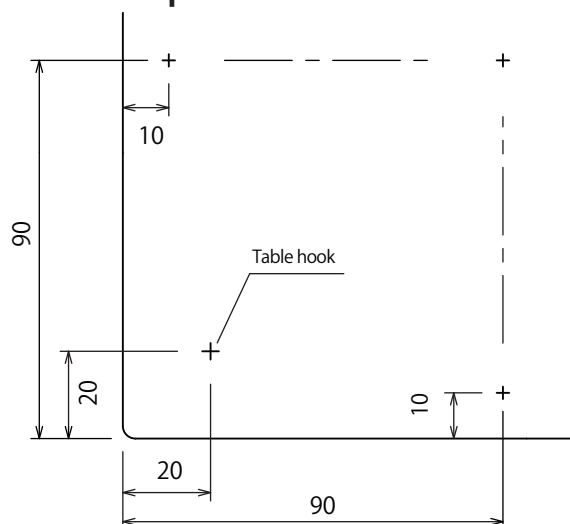

### Leg part

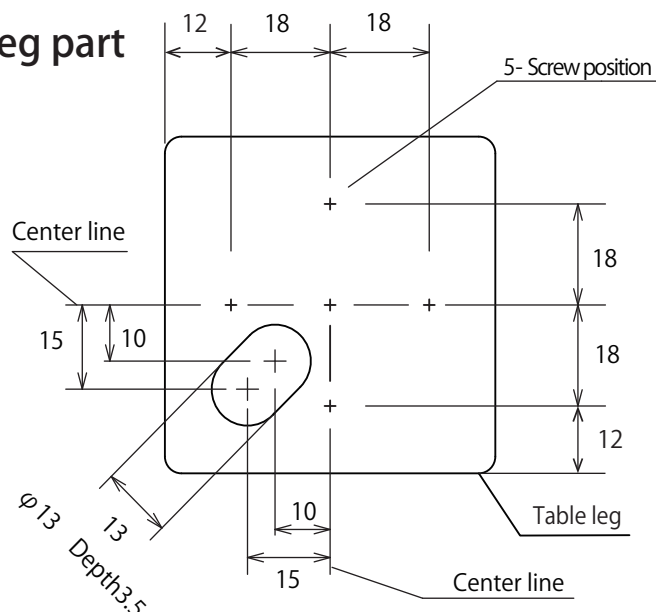

**Kojima** METAL FITTING CORPORATION

Head office

3-4-1 Motoasakusa, Taito-ku, Tokyo 111-0041, Japan

TEL +81-3-3843-3141 FAX +81-3-3843-3144

Kasukabe branch

1-26-20 Kasukabehigashi, Kasukabe-shi, Saitama 344-0062, Japan

TEL +81-48-760-3881 FAX +81-48-760-3883

✉ [kojima\\_global@kojima-mf.co.jp](mailto:kojima_global@kojima-mf.co.jp)

