

B270 Table legs metal fitting with lock PAT.P

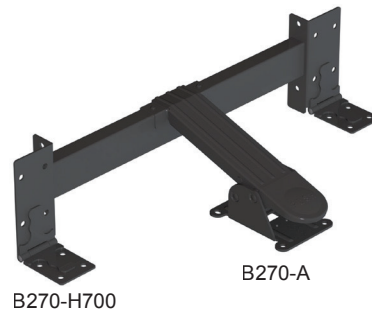

- Can be steady locked both when the table legs are standing or folded.
- Safety system not to unlock incorrectly even by accidental hit.
- Easy operate the metal fitting with a little force.
- Easy installation.



B270-A



How to install

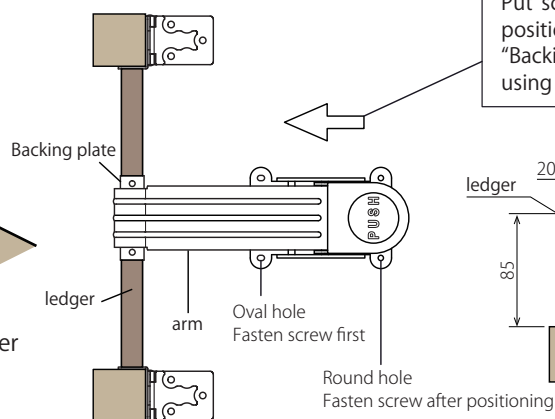
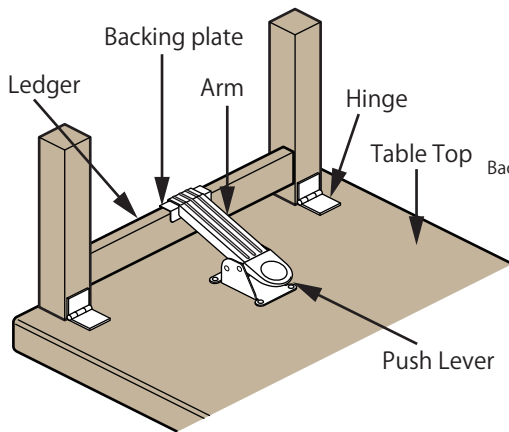

Put screws in oval holes side first, decide the position not to put a space between "Arm" and "Backing plate" and fix the round hole side using screws.

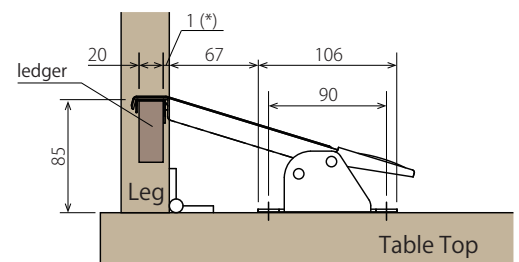

Hight from Table Top to ledger: 85mm
Width of ledger: 20 mm
* Offset 1mm from leg to ledger

To stand the legs of the table



- 1 While pressing the "Push Lever"
- 2 Stand the legs of the table

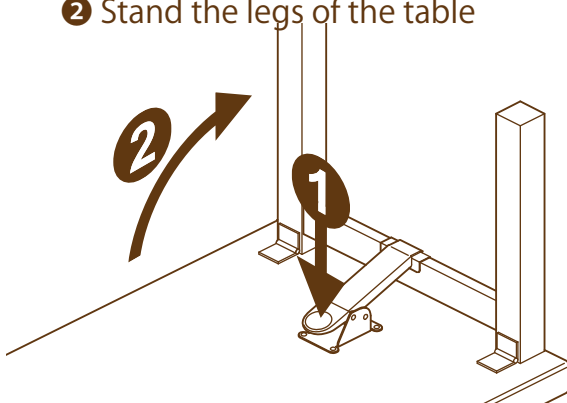

To fold the legs of the table



- 1 While pressing the "Push Lever"
- 2 Fold the legs of the table inward

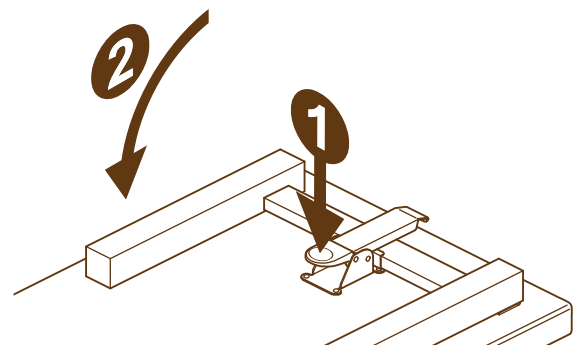

B270-A Metal Fitting Legs with locking system



- Material/ Steel
 - Finishing/ Black paint
 - Recommended screw/Body: $\phi 6$, Truss, Pan head
Backing plate: $\phi 3$, Pan head
 - Per case/20 sets (1 table needs 1 set)
 - ※ Recommended Table Top width: within 600mm,
Recommended leg thickness: 55 ~ 75mm
 - ※ The stickers of instruction manual are included.
 - ※ Use more than 2 sets for the Table Top more than 600mm.
- Ask the sales for more detail information.

Table Top
H300m/m
Maximum

※ In case of using only B270-A

In case of combination use of B270-A and F138

Table Top
H700m/m
Maximum

※ In case of combination use of B270-A and B270-H700

In case of combination use of B270-A and F137

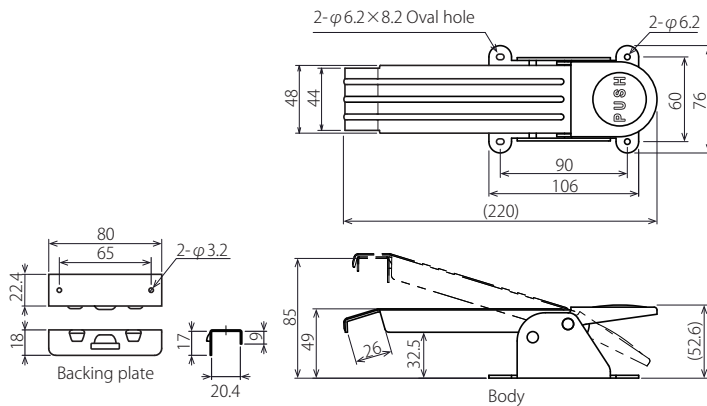

B270-H700 Ledger with hinge



- Unnecessary to install ledger
- Stronger than wooden ledger
- Material/Steel
- Finishing/Black paint
- Recommended screw/ $\phi 6$, Truss, Pan head
- Per case/10 sets (1 table needs 1 set)

Table Top
H700m/m
Maximum

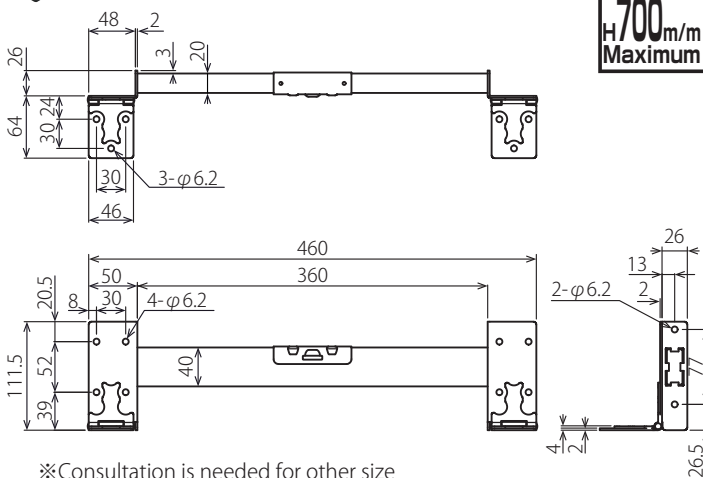

※ Consultation is needed for other size

Features of F137 and F138

Hinge with back push

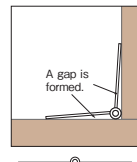

A gap is formed between screw and wood
A gap between screw and wood causes deformation of a hinge when you screw and use. It consequently happens to wobble.

Hinge without back push (F137, F138)

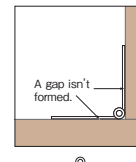

A gap isn't formed between hinge and wood.
Deformation doesn't happen when you screw or use, because there isn't a gap between a hinge and wood.
※ Can tighten a screw

F137-46-BL Enhanced version landscape hinge (old part number B270-H)

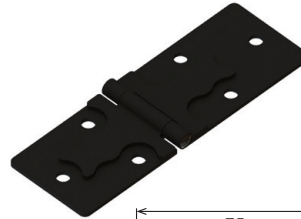

- Strong hinge for long legs
- Material/Steel
- Finishing/Black paint
- Recommended screw/ $\phi 6$, Truss, Pan head
- Per case/24 pcs.

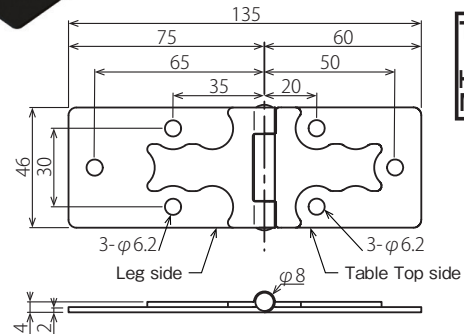

Table Top
H700m/m
Maximum

F138-38-BL Landscape hinge without back push (old part number B271)



- Can also use for other metal fittings of foldable legs beside of B270, B200, B205.
- Material/Steel
- Finishing/Black paint
- Recommended screw/ $\phi 3.5$, flat head
- Per case/ 24 pcs.

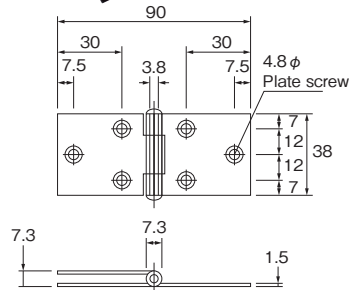
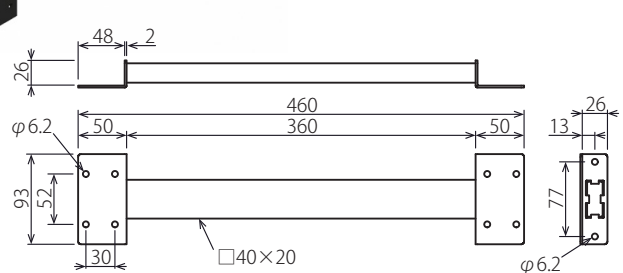

Table Top
H300m/m
Maximum

B270-Y Reinforcement Ledger



- Use to reinforce long legs
- Material/Steel
- Finishing/ Black paint
- Recommended screw/ $\phi 6$, Truss, Pan head
- Per case/10 sets (1 table needs 1 set)



Kojima METAL FITTING CORPORATION

Head office

3-4-1 Motoasakusa, Taito-ku, Tokyo 111-0041, Japan

TEL +81-3-3843-3141 FAX +81-3-3843-3144

Kasukabe branch

1-26-20 Kasukabehigashi, Kasukabe-shi, Saitama 344-0062, Japan

TEL +81-48-760-3881 FAX +81-48-760-3883

✉ kojima_global@kojima-mf.co.jp

