

# B205 Folding legs metal fitting KTL-2 Hinge

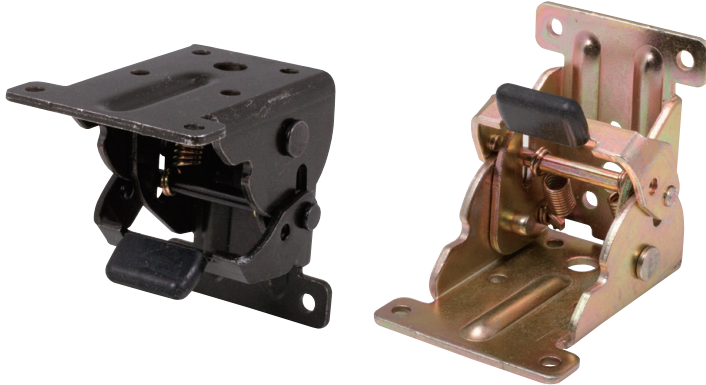

At the time of opening

At the time of closing

- Metal fitting for low table
  - Strong and compact size
  - Can fold by pulling the lever easily
  - Recommended leg: Minimum up to 50mm square × H300mm
  - Material/ Steel
- Recommended screw:  $\phi 3.5$  pan • round head (truss is no possible)



## Caution!!

Put about 0.5mm gap between table and leg. If you install without any gap, it won't be locked.

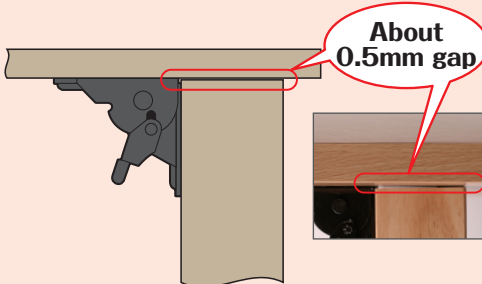

1



Fix red circled 4 points in the picture with screws in a locked state after standing a leg

2



Fix red circled 2 points in the picture with screws folding a leg

Dimension drawing at the time of folding

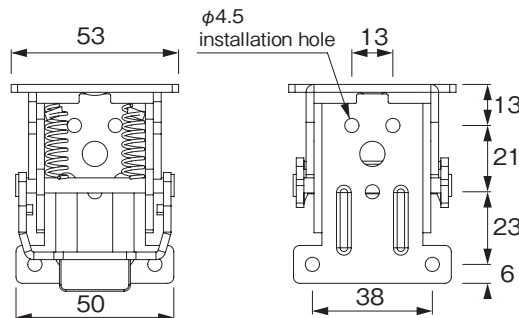
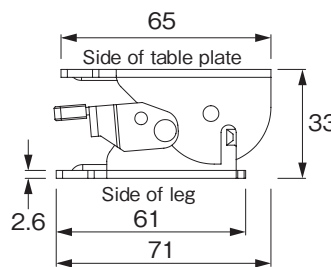

Specification dimensions

(Unit : mm)

Product number	Finishing	Quantity
B205	Chromate Black zinc	100pcs

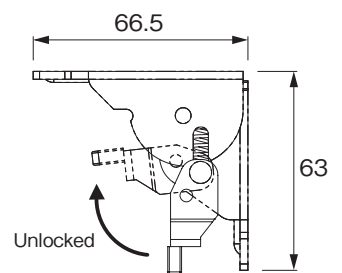
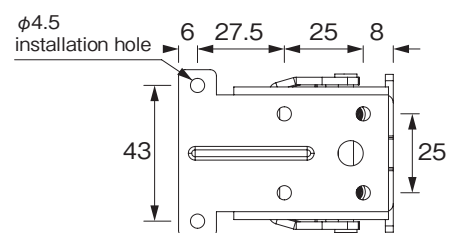

**Kojima** METAL FITTING CORPORATION

Head office

3-4-1 Motoasakusa, Taito-ku, Tokyo 111-0041, Japan

TEL +81-3-3843-3141 FAX +81-3-3843-3144

Kasukabe branch

1-26-20 Kasukabehigashi, Kasukabe-shi, Saitama 344-0062, Japan

TEL +81-48-760-3881 FAX +81-48-760-3883

✉ [kojima\\_global@kojima-mf.co.jp](mailto:kojima_global@kojima-mf.co.jp)

